



Seen from above, one can recognize the wavelike shapes of the planting beds.

## Conception

Slotsholmen is a small island located in the historical administration sector of Copenhagen, which houses, among other institutions, four ministries of the Danish central administration. Recently the courtyard of a listed office building from the 1960s was renovated. The garden is indeed visible from the outside, but only accessible to the staff and is located on the roof of a parking garage. When planning the new gardens and green areas great emphasis was placed

on a plantation which would change its colour over the course of the year, so that new impressions are constantly offered to the visitors.

The special design of the raised beds enclosed with Tombak provides a unique character to the garden. The inspiration for this design stirred from the nearby shore with its water and its waves. The resulting new roof garden is lush and green and the wave-like shapes of the beds provide an interesting contrast to the strict construction of the buildings.

## System Build-up Planting Beds

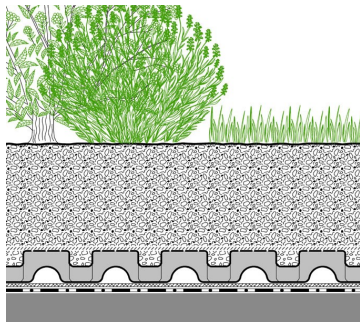

Plant layer with perennials and trees

System Substrate "Roof Garden"

Filter Sheet SF

Floradrain® FD 60, infilled with Zincolit® Plus

Protection Mat ISM 50

Roof construction with root resistant waterproofing

**Project Data**

Area: ca. 1.000 m<sup>2</sup>

Construction Year: 2014

Landscape architect:  
GHB Landscape Architects A/S,  
Copenhagen

Contractor:  
Malmos A/S, Roskilde

System Build-ups:  
"Roof Garden" with Floradrain® FD 60  
"Lawn" with Floradrain® FD 40-E

Coordinates:  
55°40'28.71"N 12°35'3.48"E

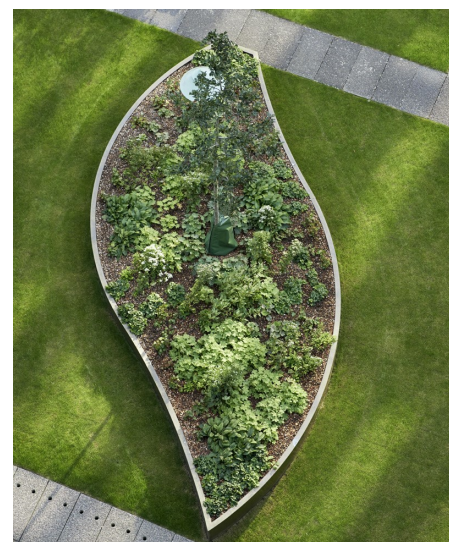

Floradrain® FD 40-E elements were installed under the lawn areas, while the planting beds which offer more substrate depth for shrubs and trees were built on Floradrain® FD 60.

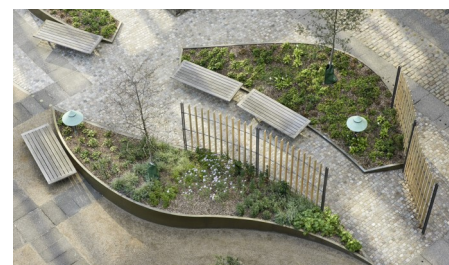
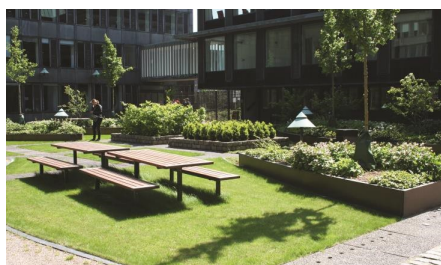

The previous garden (see picture on the left) had a very time-typical design with squares and raised beds, garden ponds and cobbled surfaces. When planning the new garden and green spaces, plant selection was carefully considered for seasonal colour variation, thus enabling constantly new perceptions and impressions to visitors.